

Cardiff Bay (South) - Proposed Controlled Parking Zone Layout

Notes

1. Where there are no parking bays indicated, the road would be covered by a double yellow line restriction. This will apply to waiting and loading across all vehicle accesses.
2. Double yellow line loading restriction times will vary according to location.
3. Motorcycle bays will be provided at suitable locations throughout the zone.

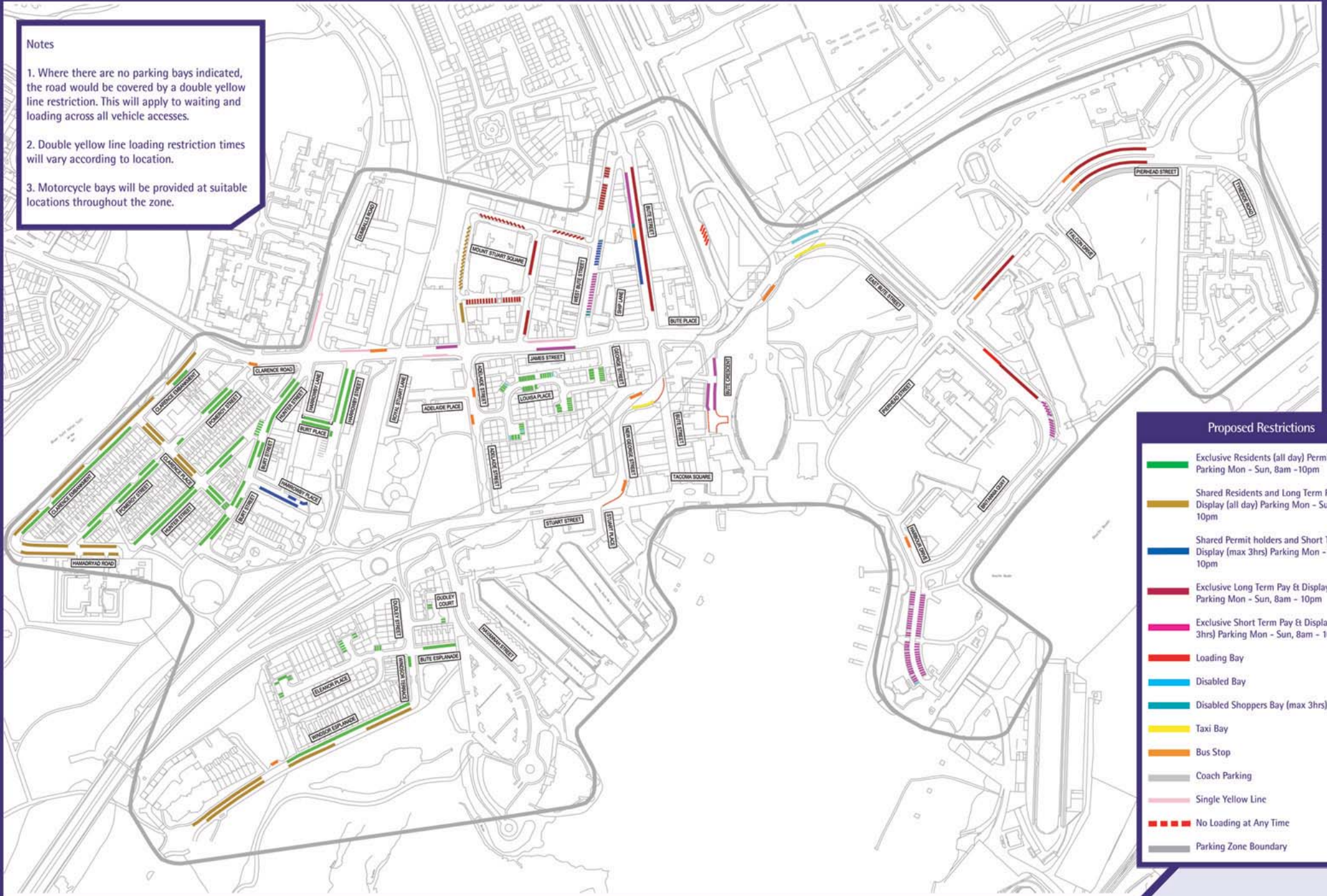

Proposed Restrictions

- Exclusive Residents (all day) Permit Parking Mon - Sun, 8am - 10pm
- Shared Residents and Long Term Pay & Display (all day) Parking Mon - Sun, 8am - 10pm
- Shared Permit holders and Short Term Pay & Display (max 3hrs) Parking Mon - Sun, 8am - 10pm
- Exclusive Long Term Pay & Display (all day) Parking Mon - Sun, 8am - 10pm
- Exclusive Short Term Pay & Display (max 3hrs) Parking Mon - Sun, 8am - 10pm
- Loading Bay
- Disabled Bay
- Disabled Shoppers Bay (max 3hrs)
- Taxi Bay
- Bus Stop
- Coach Parking
- Single Yellow Line
- - - No Loading at Any Time
- Parking Zone Boundary